

Risk Exposure and the Construction Industry

Companies lose millions of dollars each year by not utilizing data they already have

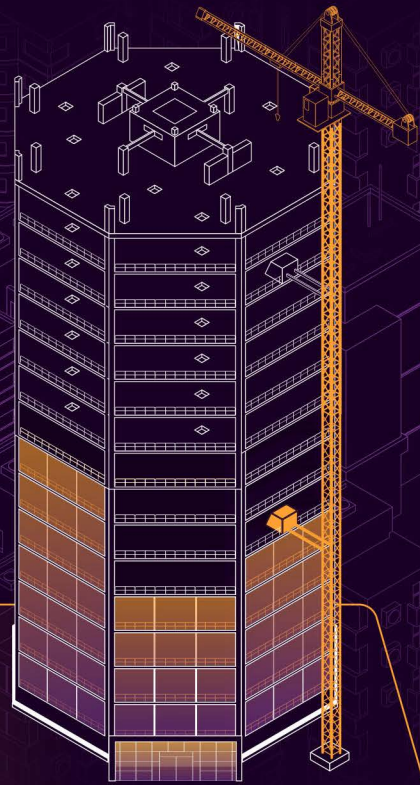

20% longer



Large projects across multiple sectors go over schedule an average of 20% longer than anticipated

80% over



Large project budgets exceed original target by an average of 80%

52% rework



52% of rework is caused by poor project data and miscommunication, costing the industry an average of \$50.4B a year

96% data unused



96% of data generated on construction sites goes unused



Critical Issue
FCU Too Low
▲ Impacts Critical Path
▲ Checkers with pending construction
Estimated Rework
\$20K
ACTION ISSUE
IGNORE & UPDATE AS BUILT

1,130 SqM
2.8 GB
676